

Flood relief and woodland scheme for Jubilee Field

The Parish Council is seeking tenders to remedy the extensive wet patch caused by machinery damage to a land drain in Jubilee Field and help mitigate surface flooding in the village by reducing the rate of the downstream flow.



The current boggy area looking towards the village gate

The scheme was designed by FWAG South West at the request of the Council. It is in keeping with the council's objective of making Jubilee Field an open access space where the area's ecology and the environment is protected and enhanced.

It is hoped the cost of the project will be considerably supported by grant funding from the 'Hills to Levels' project. The grant application is currently being submitted by FWAG (January 2020) and is envisaged that work will commence in Spring this year.

Swales

The project involves constructing two swales in the boggy area, connecting channels, installation of three 'leaky' dams and the planting of around 500 trees from the village entrance up to where the field opens out to the main area.

Intended to be fully vegetated, the two shallow swales will total approximately 153m² (90m² & 63m² respectively) with a finished depth no deeper than 500mm. The banks will be a gradient of 1 in 3 or shallower. The following diagram shows the intended construction and dimensions of the swales.

Swales: Plan Form

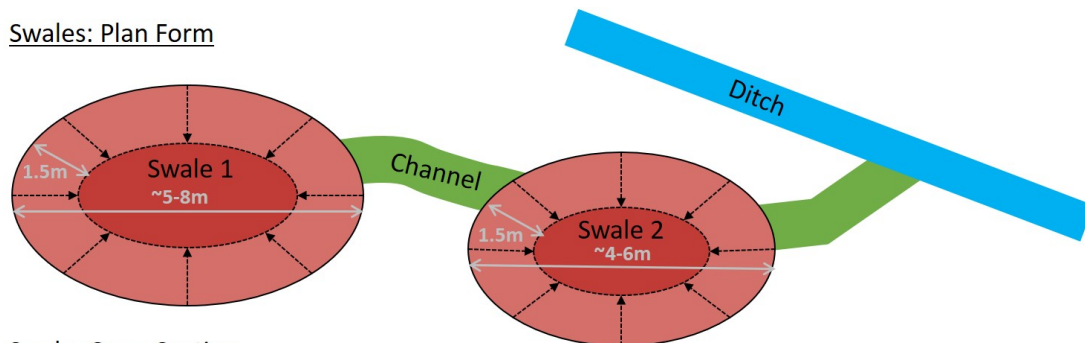

Swale: Cross Section

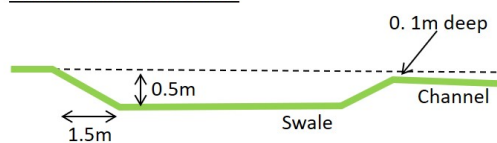

- Slopes 1 in 3 (i.e. max depth is 500mm, slope is 1500m from edge)
- Construct channels to direct overflow. These should be shallow with gentle side slopes

Leaky dams / Seepage barriers

Three leaky dams are intended to be constructed. These do not stop the flow of the stream, but will hold back the water for a time if there is surge in volumes. They are proven to effectively allow the water downstream to drain easier. Following is a diagram and picture of a typical leaky dam structure.

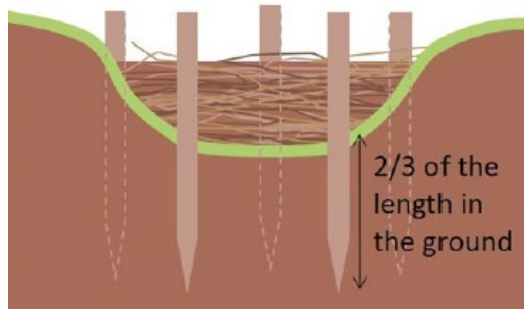

Seepage barrier secure with stakes



Example using hazel

The swales and length of the stream containing the leaky dams will be protected by a sheep wire fence, although in keeping with the desire to provide unrestricted access there will be a gate into this fenced section on the western side.

Tree planting

An extensive 0.35 ha woodland is also being created by planting 500 mixed species of trees and shrubs from the village access gate, around the two

swales and up to where the field broadens out to its full width. The trees are an essential element of the project as they take up water, improve infiltration, and increase ground surface roughness to slow runoff.

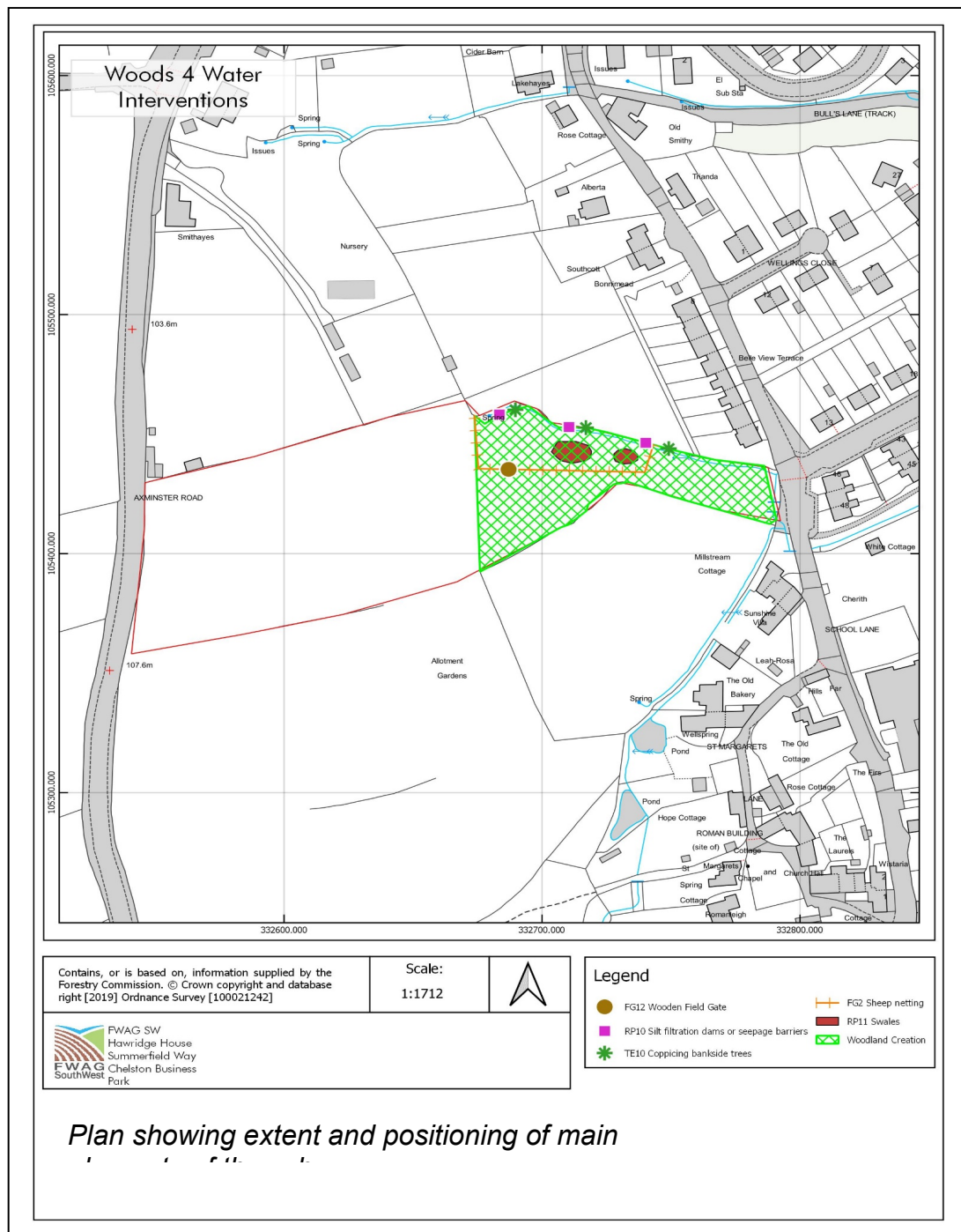

Residents' views are welcomed – please send any comments to The Parish Council at The Parish Office, Tatworth Memorial Hall, Kents Road, TA20 2QA. clerk@tatworthandfortonparishcouncil.org.uk